

**Access Hole Plug Kit 22-88847A1**  
 Contains all necessary parts (including template) to allow removal of swivel shaft without removing gimbal housing.

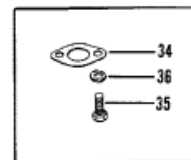

Parts List						
Ref	Class	Part	Description	Qty	Comment	Footnote
1		94989A 6	GIMBAL HOUSING ASSEMBLY	1		
2	16	56296	STUD, GIMBAL HOUSING TO T	2		
3	31	32536	ROLLER BEARING, GIMBAL HO	1		
4	26	32911	OIL SEAL, LOWER GIMBAL HO	2		
5	31	21145	ROLLER BEARING, GIMBAL HO	1		
6	26	54925	OIL SEAL, UPPER GIMBAL HOL	1		
7	22	74036	GREASE FITTING, GIMBAL HOL	2		
8	19	77633Q	LUBRICAP, GIMBAL HOUSING	2		
9	26	88416	GREASE SEAL, GIMBAL HOUSI	1		
10	30	60794A 4	BEARING ASSEMBLY, GIMBAL	1		12
11		61075	TOLERANCE RING, GIMBAL F	1		12
13		41802	"O" RING, EXHAUST SEAL	1		
14	16	56766	STUD, HYDRAULIC CONNECTC	2		
15	17	45212	SWIVEL PIN, GIMBAL HOUSING	1		
16	18	34212	COTTER PIN, LOWER SWIVEL PI	1		
17	12	32518	WASHER, LOWER SWIVEL PIN	1		
18		55989A 8	BOLT ASSEMBLY, ANODIC	2		
19		55989Q 9	ANODIC HEAD, BOLT	2		
20	12	56085	WASHER, ANODIC BOLT	2		
21	12	32620	WASHER, GIMBAL HOUSING BOI	2		
22		74639A 2	BELLOWS, SHIFT ACTUATING C	1		11,12
23	54	38863	CLAMP, ACTUATING CABLE BEL	1		11,12
24	54	815504320	CLAMP, ACTUATING CABLE BEL	1		11,12
25	12	34567	WASHER, GIMBAL HOUSING STI	2		
26	11	826710 15	NUT, GIMBAL HOUSING STUD	2		
27	32	86907 1	TUBE, WATER -5/8" I.D. WATER	1		
27	32	41672 1	TUBE, WATER (3/4" I.D. WATER	1		
28	23	28055	BUSHING, RUBBER - WATER TU	1		
28	23	41675 1	BUSHING, RUBBER - WATER TU	1		
29		32517	COVER, WATER TUBE (5/8" I.D.	1		
29		41673	COVER, WATER TUBE (3/4" I.D.	1		
30	10	28635	SCREW, COVER TO GIMBAL HOL	2		
31		65533A 1	SEAL, GIMBAL HOUSING TO TRA	1		
32	27	98823 1	GASKET, HYDRAULIC CONNECT	1		
33		98825A 4	CONNECTOR, HYDRAULIC	1		
34	27	99506 1	GASKET, CONNECTOR COVER	1		
35	10	28636	SCREW, CONNECTOR COVER	2		
36	13	78968	LOCKWASHER, CONNECTOR C	2		
37	13	78968	LOCKWASHER, HYDRAULIC CON	2		
38	11	826711 9	NUT, HYDRAULIC CONNECTOR	2		
39		57222T	COVER, GIMBAL HOUSING	1		